



61 Celia Crescent, Ashford, TW15 3NP

£400,000



## 61 Celia Crescent, Ashford, TW15 3NP

This extended two bedroom semi detached bungalow is in need of some updating and is situated in a popular location moments from Fordbridge Park. Accommodation comprises of two bedrooms (one currently being used as living area), dining room and conservatory. Other notable features include kitchen, bathroom, driveway parking, double glazing, car port/garage and private enclosed rear garden. The property also benefits from having the potential to extend (stpp) and has superb access to both Staines-Upon-Thames and Ashford town centre. No Onward Chain.



## Floor Plan

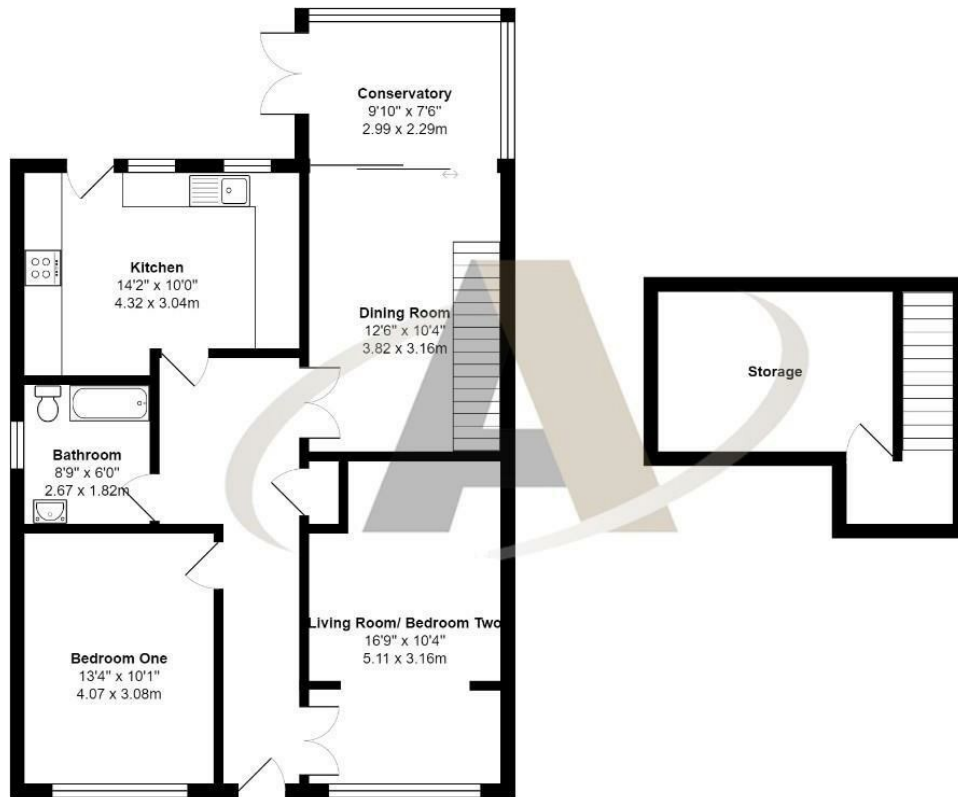

Celia Crescent, Ashford, TW15 3NP

Total Area: 1071 ft<sup>2</sup> ... 99.5 m<sup>2</sup>

All measurements are approximate and for display purposes only



## Features

- Two Bedrooms
- In Need Of Some Updating
- Car Port/Garage
- Potential To Extend (stpp)
- Conservatory
- Driveway Parking
- Enclosed Private Rear Garden
- No Onward Chain



